

10HPL64

8Ω**LF Drivers** - 10.0 Inches

- 400 W continuous program power capacity
- 64 mm (2.5 in) aluminium voice coil
- 60 - 4000 Hz response
- 98.5 dB sensitivity
- Neodymium magnet allows a very light yet powerful motor assembly

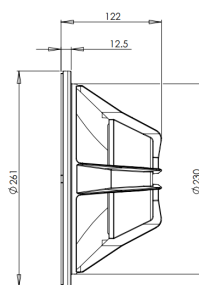
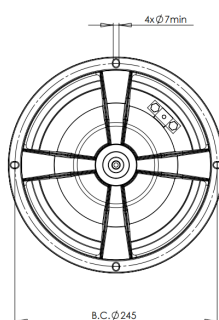

10HPL64

LF Drivers- 10.0 Inches

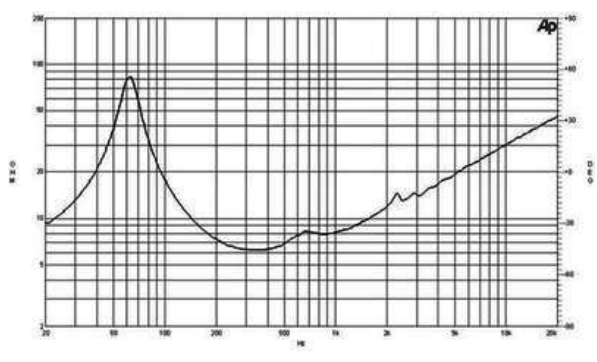
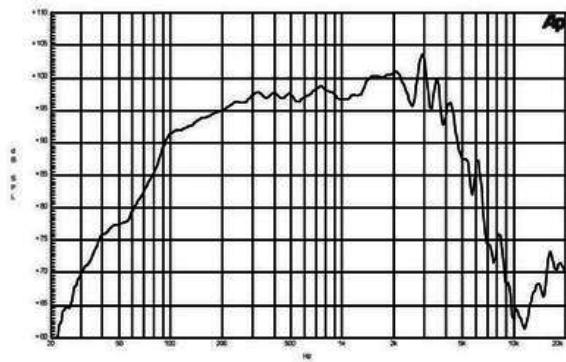

SPECIFICATIONS

| | |
|--|-------------------|
| Nominal Diameter | 250 mm (10.0 in) |
| Nominal Impedance | 8 Ω |
| Minimum Impedance | 6.2 Ω |
| Nominal Power Handling ¹ | 200 W |
| Continuous Power Handling ² | 400 W |
| Sensitivity ³ | 98.5 dB |
| Frequency Range | 60 - 4000 Hz |
| Voice Coil Diameter | 64 mm (2.5 in) |
| Winding Material | Aluminium |
| Former Material | Glass Fibre |
| Winding Depth | 12.0 mm (0.47 in) |
| Magnetic Gap Depth | 8.0 mm (0.31 in) |
| Flux Density | 1.25 T |

DESIGN

| | |
|-----------------------|--|
| Surround Shape | Double Roll |
| Cone Shape | Exponential |
| Magnet Material | Neodymium Inside Slug |
| Spider | Single |
| Pole Design | Straight Pole |
| Woofer Cone Treatment | None |
| Recommended Enclosure | 26.0 dm ³ (0.92 ft ³) |
| Recommended Tuning | 67 Hz |

PARAMETERS⁴

| | |
|---------------------|---|
| Resonance Frequency | 61 Hz |
| R _e | 5.4 Ω |
| Q _{es} | 0.33 |
| Q _{ms} | 4.5 |
| Q _{ts} | 0.31 |
| V _{as} | 32.0 dm ³ (1.1 ft ³) |
| S _d | 320.0 cm ² (50.0 in ²) |
| η_o | 2.5 % |
| X _{max} | 4.0 mm |
| X _{var} | 5.5 mm |
| M _{ms} | 29.0 g |
| Bl | 15.0 Txm |
| Le | 0.5 mH |
| EBP | 184 Hz |

MOUNTING AND SHIPPING INFO

| | |
|-------------------------------|---|
| Overall Diameter | 261 mm (10.3 in) |
| Bolt Circle Diameter | 245 mm (9.6 in) |
| Baffle Cutout Diameter | 230.0 mm (9.1 in) |
| Depth | 122 mm (4.8 in) |
| Flange and Gasket Thickness | 13 mm (0.5 in) |
| Air Volume Occupied by Driver | 1.5 dm ³ (0.05 ft ³) |
| Net Weight | 2.0 kg (4.4 lb) |
| Shipping Units | 1 |
| Shipping Weight | 2.6 kg (5.7 lb) |
| Shipping Box | 295x314x175 mm (11.61x12.36x6.89 in) |

SERVICE KIT

| | |
|------------|--------------|
| Recone kit | RCK010HPL648 |
|------------|--------------|

- 2 hours test made with continuous pink noise signal within the range Fs-10Fs. Power calculated on rated minimum impedance. Loudspeaker in free air.
- Power on Continuous Program is defined as 3 dB greater than the Nominal rating.
- Applied RMS Voltage is set to 2.83 V for 8 ohms Nominal Impedance.
- Thiele-Small parameters are measured after a high level 20 Hz sine wave preconditioning test.

B&C Speakers s.p.a.

Via Poggiomoro, 1 - Loc. Vallina, 50012 Bagno a Ripoli (FI) - ITALY - Tel. +39 055 65721 - Fax +39 055 6572312 - mail@bcspeakers.com